

Picture shows HST-MA2 with variation code VC0001795.

Intended use

The solenoid controlled switch HST-ME2 / HST-MA2 is used to switch off the power supply to the load circuits of machines or plants with shut-off delays, with rated currents up to 20A, in accordance with the conditions of section 19, if the hazardous movements have been shut down.

If the coded switch key is in position 0, the coded key change can be turned and removed.

Other applications are prohibited.

Function

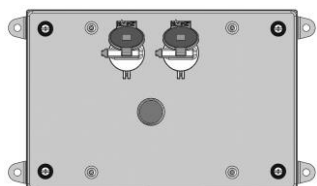

Position 1:
Switch key and change key are blocked by locking mechanism. Key cannot be removed.

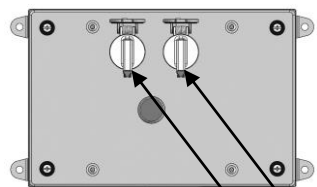

Position 0:
Switch key and change key are released and can be removed.

Change key
Switch key

Article	Variation code	Pin connections	Power supply
60056	VC0001807	2 NC / 2 NO	230 VAC
60056	VC0001795	2 NC / 2 NO	230 VAC

Technical data

Environment:	Indoor/outdoor
Temperature range:	-20°C to +40°C
Humidity:	Up to 100% (standard climate)
Material	
Lock:	Stainless steel
Mounting plate:	Galvanised steel
Earthing plate:	Galvanised steel
Housing:	Powder-coated sheet steel
Ambient atmosphere:	Industrial environments
Mounting position:	All positions
Mechanical service life	
Lock:	280.000 actuations
Switch:	1.000.000 actuations
Mission time:	15 years
B10d-values	
Switch;	
Rated operating current	
16/20 A:	36.000 switching operations
Switch;	
for 24 V DC and 0,21 A:	1.000.000 (in conjunction with PNOZ X3)
MTTFd:	Depending on application
Protection class:	IP 65
Reference standard for rotary switch:	EN 60947-3

Dimensions housing version HST-MA2

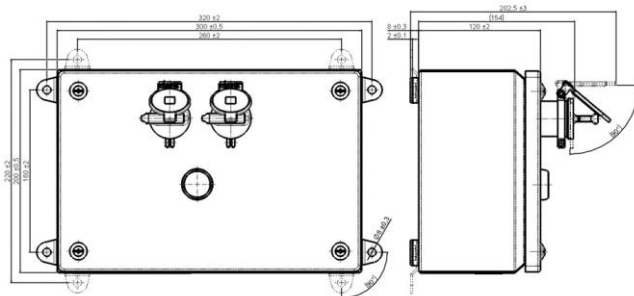

All dimensions in mm.



Haake Technik GmbH
Master Esch 72
48691 Vreden
Deutschland

info@haake-technik.com
www.haake-technik.com
T: +49 (0) 2564 3965 0
F: +49 (0) 2564 3965 90