

# Foot Protection Switch HFS-FS



Safety for pallet trucks

# The handling of pallet trucks can be dangerous.

## Especially for your feet!



Pallet trucks are equipped with technical safety devices and conform to the requirements of the Machinery Directive 2006/42/EC.



Nevertheless, the risk of injury when handling these vehicles is high.



The most common injuries include foot injuries, which sometimes result in long periods of absence of several weeks or even months.



The main cause of accidents: time pressure. The machines are often operated at maximum speed.

# However, the risk of accidents can be reduced

## The Haake Foot Protection Switch HFS-FS



Go to the video



1

Vehicle equipped with foot protection switch.  
No collision with the foot.



2

Vehicle equipped with foot protection switch.  
Collision with foot detected. Vehicle stops.



3

Vehicle equipped with foot protection switch.  
After collision and stop, the vehicle reverses. 3

# The structure of the Haake Foot Protection Switch HFS-FS

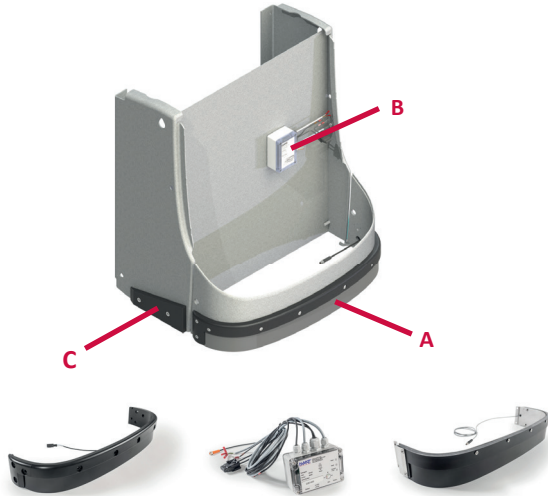

**Area Sensor [A]** The Area sensor provides the controller with a signal which changes when actuated (application of pressure). The deflector plate and the sensor are available in a smart spare part concept. These components can be easily replaced without disassembling the total area sensor.

**Controller [B]** The Controller processes the signals of the area sensor and thus generates safety-relevant signals for the interruption of one or more circuits.

**Lateral deflector kit [C]** The vehicle-specific deflectors absorb lateral forces and thus extend the availability of the area sensor.

A circular icon containing a white hand holding a document with a checklist, set against a blue background.

## The Features

- Highly sensitive pressure sensor
- High robustness against mechanical influences
- Adaptability to almost any vehicle shape

A circular icon containing a white hand holding a red diamond, set against a blue background.

## Your benefit

- You significantly reduce the risk of accidents when handling pallet trucks
- You reduce accident-related absences and consequently your loss of wages costs in the company
- You ensure a safer working environment and more satisfied operators



Different versions  
available for different  
brands and vehicle types.

**Contact us!**



Founded 1987 as a family business



Specialist for industrial safety technology



Global locations and sales partners



Continuous product development within the framework of standards and guidelines at the highest level



Certified according to ISO 9001, ISO 14001 and ISO 45001

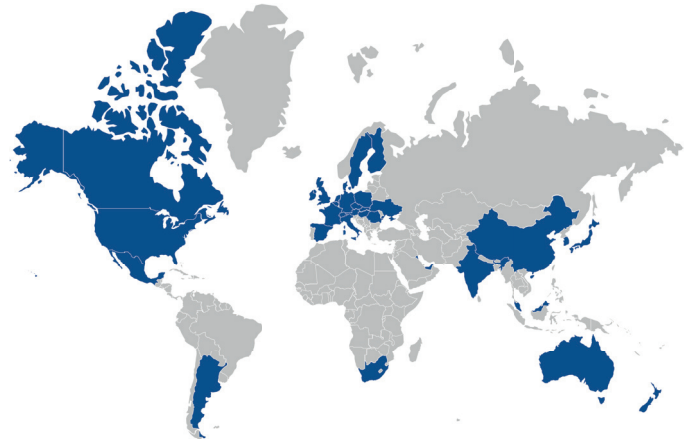

**Excited about our safety solution?**  
**We will be happy to advise you!**

**HAAKE**®

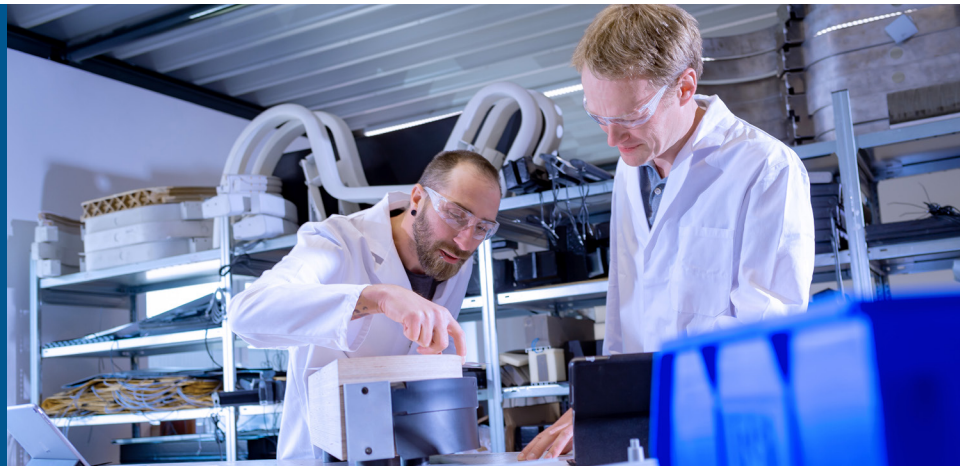

Haake Technik GmbH • Master Esch 72 • D-48691 Vreden • Telefon: +49 2564 3965-0 • [info@haake-technik.com](mailto:info@haake-technik.com) • [www.haake-technik.com](http://www.haake-technik.com)